



STEMCO®

Standard Product Catalogue

Mfg. Range

- Copper & Aluminium Terminals
- Stainless Steel Cable Ties & Accessories
- Copper, Copper Bonded Earth Rods & Earthing Accessories
- Insulated & Brazed Terminals
- Brass Cable Glands
- Crimping & Cutting Tools



COPPER TUBULAR TERMINALS WITH INSPECTION VENT

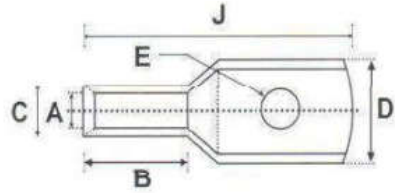

Material : ETP Grade Copper to BS-1977, Finish : Electro-tinned

Cable mm ²	Stud Hole E	B	D	A	C	J	CAT No.
1.5	M 4	5.5	8.0	1.8	3.7	17.0	CEHD 1.5-4
1.5	M 5	5.5	8.0	1.8	3.7	17.0	CEHD 1.5-5
1.5	M 6	5.5	9.5	1.8	3.7	19.0	CEHD 1.5-6
2.5	M 4	8.0	8.5	2.4	4.0	21.5	CEHD 2.5-4
2.5	M 5	8.0	8.5	2.4	4.0	21.5	CEHD 2.5-5
2.5	M 6	8.0	9.5	2.4	4.0	21.5	CEHD 2.5-6
2.5	M 8	8.0	11.0	2.4	4.0	24.0	CEHD 2.5-8
4	M 4	8.0	9.5	3.1	4.8	21.0	CEHD 4-4
4	M 5	8.0	9.5	3.1	4.8	21.0	CEHD 4-5
4	M 6	8.0	9.5	3.1	4.8	21.0	CEHD 4-6
4	M 8	8.0	11.0	3.1	4.8	23.0	CEHD 4-8
6	M 5	10.0	9.5	3.8	5.5	23.0	CEHD 6-5
6	M 6	10.0	10.5	3.8	5.5	27.0	CEHD 6-6
6	M 8	10.0	11.0	3.8	5.5	27.0	CEHD 6-8
6	M 10	10.0	14.5	3.8	5.5	32.0	CEHD 6-10
10	M 5	10.0	10.5	4.5	6.2	25.5	CEHD 10-5
10	M 6	10.0	10.5	4.5	6.2	25.5	CEHD 10-6
10	M 8	10.0	11.5	4.5	6.2	27.5	CEHD 10-8
10	M 10	10.0	14.5	4.7	7.1	32.0	CEHD 10-10
10	M 12	10.0	18.0	4.7	7.1	36.0	CEHD 10-12
16	M 5	13.0	11.5	5.4	7.1	31.0	CEHD 16-5
16	M 6	13.0	11.5	5.4	7.1	31.0	CEHD 16-6
16	M 8	13.0	11.5	5.4	7.1	31.0	CEHD 16-8
16	M 10	13.0	14.5	5.5	7.9	35.0	CEHD 16-10
16	M 12	13.0	18.0	5.5	7.9	39.0	CEHD 16-12
20	M 8	13.0	11.5	6.0	7.7	32.5	CEHD 20-8
25	M 6	14.0	12.5	6.8	8.8	33.0	CEHD 25-6
25	M 8	14.0	13.0	6.8	8.8	33.0	CEHD 25-8
25	M 10	14.0	14.5	6.8	8.8	36.5	CEHD 25-10
25	M 12	14.0	16.5	6.8	8.8	40.0	CEHD 25-12
35	M 6	14.0	15.0	8.2	10.6	36.0	CEHD 35-6
35	M 8	14.0	15.0	8.2	10.6	36.0	CEHD 35-8
35	M 10	14.0	16.0	8.2	10.6	39.0	CEHD 35-10
35	M 12	15.5	21.0	8.2	10.6	47.0	CEHD 35-12
50	M 6	18.0	18.0	9.5	12.4	45.0	CEHD 50-6
50	M 8	18.0	18.0	9.5	12.4	45.0	CEHD 50-8
50	M 10	18.0	18.0	9.5	12.4	45.0	CEHD 50-10
50	M 12	22.0	21.0	9.5	12.4	52.0	CEHD 50-12
50	M 14	18.0	22.0	9.5	12.4	52.0	CEHD 50-14
50	M 16	18.0	22.0	9.5	12.4	52.0	CEHD 50-16
70	M 6	20.0	21.0	11.2	14.7	52.0	CEHD 70-6
70	M 8	20.0	21.0	11.2	14.7	52.0	CEHD 70-8
70	M 10	20.0	21.0	11.2	14.7	52.0	CEHD 70-10
70	M 12	20.0	21.0	11.2	14.7	52.0	CEHD 70-12
70	M 14	20.0	25.0	11.2	14.7	55.0	CEHD 70-14
70	M 16	20.0	25.0	11.2	14.7	55.0	CEHD 70-16

Cable mm ²	Stud Hole E	B	D	A	C	J	CAT No.
70	M 20	20.0	28.0	11.2	14.7	57.0	CEHD 70-20
95	M 8	22.0	25.0	13.5	17.4	57.0	CEHD 95-8
95	M 10	22.0	25.0	13.5	17.4	57.0	CEHD 95-10
95	M 12	22.0	25.0	13.5	17.4	57.0	CEHD 95-12
95	M 14	22.0	26.0	13.5	17.4	57.0	CEHD 95-14
95	M 16	22.0	26.0	13.5	17.4	60.0	CEHD 95-16
95	M 20	22.0	28.0	13.5	17.4	60.0	CEHD 95-20
120	M 8	24.0	28.0	15.0	19.4	63.0	CEHD 120-8
120	M 10	24.0	28.0	15.0	19.4	63.0	CEHD 120-10
120	M 12	24.0	28.0	15.0	19.4	63.0	CEHD 120-12
120	M 14	24.0	29.0	15.0	19.4	63.0	CEHD 120-14
120	M 16	24.0	28.0	15.0	19.4	63.0	CEHD 120-16
120	M 20	24.0	31.0	15.0	19.4	70.0	CEHD 120-20
150	M 8	29.0	30.5	16.5	21.2	71.0	CEHD 150-8
150	M 10	29.0	30.5	16.5	21.2	71.0	CEHD 150-10
150	M 12	29.0	30.5	16.5	21.2	71.0	CEHD 150-12
150	M 14	29.0	30.5	16.5	21.2	71.0	CEHD 150-14
150	M 16	29.0	30.5	16.5	21.2	71.0	CEHD 150-16
150	M 20	29.0	30.5	16.5	21.2	71.0	CEHD 150-20
185	M 10	34.0	34.0	18.5	23.5	79.0	CEHD 185-10
185	M 12	34.0	34.0	18.5	23.5	79.0	CEHD 185-12
185	M 14	34.0	34.0	18.5	23.5	79.0	CEHD 185-14
185	M 16	34.0	34.0	18.5	23.5	79.0	CEHD 185-16
185	M 20	34.0	34.0	18.5	23.5	79.0	CEHD 185-20
240	M 10	39.0	38.0	21.0	26.5	93.0	CEHD 240-10
240	M 12	39.0	38.0	21.0	26.5	93.0	CEHD 240-12
240	M 14	39.0	38.0	21.0	26.5	93.0	CEHD 240-14
240	M 16	39.0	38.0	21.0	26.5	93.0	CEHD 240-16
240	M 20	39.0	38.0	21.0	26.5	93.0	CEHD 240-20
300	M 10	44.0	43.0	23.5	30.0	101.0	CEHD 300-10
300	M 12	44.0	43.0	23.5	30.0	101.0	CEHD 300-12
300	M 14	44.0	43.0	23.5	30.0	101.0	CEHD 300-14
300	M 16	44.0	43.0	23.5	30.0	101.0	CEHD 300-16
300	M 20	44.0	43.0	23.5	30.0	101.0	CEHD 300-20
400	M 10	47.0	50.0	26.8	34.8	116.0	CEHD 400-10
400	M 12	47.0	50.0	26.8	34.8	116.0	CEHD 400-12
400	M 14	47.0	50.0	26.8	34.8	116.0	CEHD 400-14
400	M 16	47.0	50.0	26.8	34.8	116.0	CEHD 400-16
400	M 20	47.0	50.0	26.8	34.8	116.0	CEHD 400-20
500	M 16	52.0	55.5	30.0	39.0	126.0	CEHD 500-16
500	M 20	52.0	55.5	30.0	39.0	126.0	CEHD 500-20
630	M 16	59.0	64.5	35.0	45.0	146.0	CEHD 630-16
630	M 20	59.0	64.5	35.0	45.0	146.0	CEHD 630-20
800	-	78.0	72.5	39.0	50.6	171.0	CEHD 800
1000	-	90.0	80.5	43.0	56.2	202.0	CEHD 1000

COPPER REDUCER TYPE PIN CONNECTORS

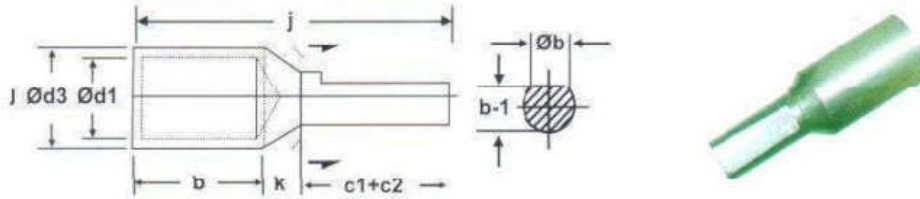

Size mm ²	Ød1	Ød3	Øb	b1	b	k	c1+c2	j	CAT NO.
2.5	2.5	4.7	4.5	4.5	6	4	10	20	RC2K-1
2.5	2.5	4.7	3.8	3.3	6	4	10	20	RC2K-7
4	2.8	4.7	4.5	4.0	6	4	10	20	RC2K-15
4	2.8	4.7	3.8	3.3	6	4	10	20	RC2K-16
6	3.1	4.7	4.5	4.0	6	4	10	20	RC2K-17
6	3.1	4.7	3.8	3.3	6	4	10	20	RC2K-18
10	3.8	5.5	4.5	4.0	9	4	10	23	RC2K-19
10	3.8	5.5	3.8	3.3	9	4	10	23	RC2K-20
10	4.4	6.2	4.5	4.0	9	4	10	23	RC2K-21
10	4.4	6.2	3.8	3.3	9	4	10	23	RC2K-22
16	5.3	7.1	6.0	5.5	12	5	15	32	RC2K-23
16	5.3	7.1	6.0	5.5	12	5	20	37	RC2K-24
16	5.3	7.1	3.8	3.3	12	5	13	30	RC2K-2
25	7.0	9.0	6.0	5.5	12	5	15	32	RC2K-25
25	7.0	9.0	7.5	6.5	12	5	20	37	RC2K-3
35	8.0	10.0	7.5	6.5	12	5	20	37	RC2K-4
50	9.2	11.2	7.5	6.5	18	5	20	41	RC2K-26
50	10.4	14.0	14.0	13.0	18	7	24	49	RC2K-5
70	11.5	13.8	7.5	6.5	18	5	20	43	RC2K-27
70	11.5	13.8	11.5	10.5	18	5	25	48	RC2K-6
70	11.5	13.8	11.5	10.5	18	5	32	55	RC2K-28
95	12.8	15.6	11.5	10.5	20	6	25	51	RC2K-29
95	12.8	15.6	15.6	14.0	20	6	27	53	RC2K-8
95	12.8	15.6	7.5	6.5	20	6	22	46	RC2K-31
95	12.8	15.6	12.8	11.8	20	6	32	58	RC2K-32
120	14.8	17.8	11.5	10.5	22	6	25	53	RC2K-33
120	14.8	17.8	7.5	6.5	22	6	22	50	RC2K-34
120	14.8	17.8	11.5	10.5	22	6	32	60	RC2K-35
120	14.8	17.8	15.6	14.0	22	6	32	60	RC2K-36
150	16.0	19.6	15.6	14.0	26	6	32	64	RC2K-10
150	16.0	19.6	11.5	10.5	26	6	32	64	RC2K-37
185	18.0	22.0	15.6	14.0	32	6	32	70	RC2K-30
185	18.0	22.0	11.5	10.5	32	6	32	70	RC2K-38
225	20.0	26.0	15.6	14.0	38	8	32	78	RC2K-39
225	20.0	26.0	21.0	18.0	38	8	42	88	RC2K-46
225	20.0	26.0	16.0	15.0	38	8	42	88	RC2K-42
240	22.0	26.0	16.0	15.0	38	8	42	88	RC2K-44
240	22.0	26.0	15.6	14.0	38	8	32	78	RC2K-43
300	24.0	26.7	16.0	15.0	42	8	42	92	RC2K-45
300	24.0	28.7	15.6	14.0	42	8	32	82	RC2K-47
400	27.0	33.2	15.6	14.0	46	12	32	90	RC2K-101

MATERIAL: COPPER IS - 191

FINISH: TIN PLATED

COPPER RING TONGUE TYPE TERMINALS (BRAZED)

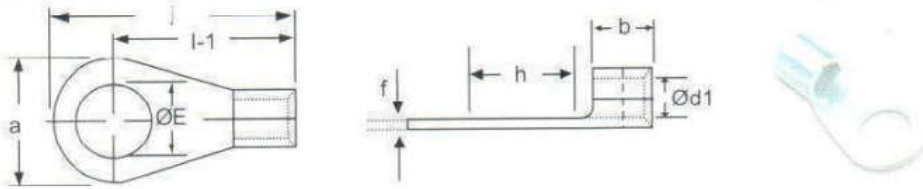

Size mm ²	ØE	Ød1	a	b	h	l-1	j	f	CAT NO.
95	M10	13.5	22	20	10	35	46	2.3	CR2K-7143
95	M10	13.5	24	20	12	38	50	2.3	CR2K-7144
95	M12	13.5	24	20	12	38	50	2.3	CR2K-7044
95	M16	13.5	28	20	17	44	58	2.3	CR2K-7145
120	M12	15.0	26	22	7	39	52	2.6	CR2K-7146
120	M16	15.0	32	22	19	48	64	2.6	CR2K-7147
120	M20	15.0	40	22	20	52	72	2.6	CR2K-7148
150	M12	16.5	34	24	16	49	66	3.6	CR2K-7149
150	M16	16.5	34	24	16	49	66	3.6	CR2K-7045
150	M16	16.5	40	24	20	54	74	3.6	CR2K-7150
150	M20	16.5	40	24	20	54	74	3.6	CR2K-7046

MATERIAL : COPPER IS - 1897

FINISH: TINPLATED

COPPER PIN TYPE TERMINALS (BRAZED, INSULATED & PRE-INSULATED)

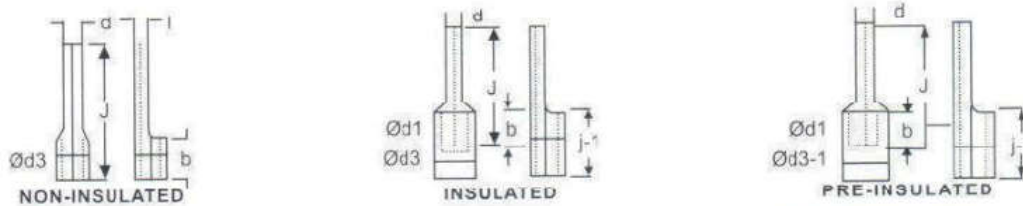

Size mm ²	d1	d3	d	b	j	CAT NO.	f	j-1	CAT NO.	d3-1	CAT NO.
1.5	1.6	3.2	1.9	5	17	PB2K-9	0.8	10	PI2K-17	3.6	PD2K-26
1.5	1.6	3.2	3.1	5	17	PB2K-9F	0.8	10	PI2K-40	3.6	PD2K-40
2.5	2.3	3.9	1.9	5	17	PB2K-1	0.8	10	PI2K-18	4.4	PD2K-27
2.5	2.3	3.9	3.1	5	17	PB2K-2	0.8	10	PI2K-19	4.4	PD2K-28
4.0	2.9	4.9	2.7	6	20	PB2K-3	1.0	14	PI2K-20	6.4	PD2K-29
6.0	3.6	5.6	2.7	6	20	PB2K-5	1.0	14	PI2K-22	6.4	PD2K-31
10	4.5	6.7	4.3	8	22	PB2K-7	1.1	16	PI2K-24		
16	5.8	8.2	5.5	10	26	PB2K-8	1.2	16	PI2K-25		
25	7.5	11.1	7.0	11	31	PB2K-25					
35	9.0	12.6	8.0	12	37	PB2K-35					
50	10.5	14.1	9.0	16	42	PB2K-50					
70	12.0	16.0	10.0	18	45	PB2K-70					
95	13.8	18.7	11.0	21	52	PB2K-95					

MATERIAL: COPPER IS -1897

FINISH TINPLATED

PIN TYPE INSULATED TERMINALS

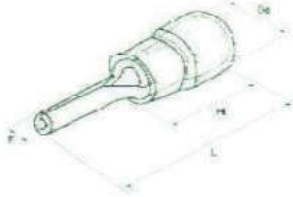

Material

Insulation : Flared PVC
Terminal : ETP Copper
Finish : Tin Plated

Part No.	Dimension(mm)				Color
	F	L	H	D	
PIR 1.5-9	1.9	19.0	10.0	4.3	Red
PIR 1.5-10	1.9	20.0			
PIR 1.5-12	1.9	22.0			
PIR 1.5-13	1.9	23.0			
PIR 1.5-18	1.9	28.0			
PIR 2.5-9	1.9	19.0	10.0	4.9	Blue
PIR 2.5-10	1.9	20.0			
PIR 2.5-12	1.9	22.0			
PIR 2.5-13	1.9	23.0			
PIR 2.5-18	1.9	28.0			
PIR 4-6-13	2.8	25.5	13.0	6.7	Yellow

PIN TYPE BRAZED TERMINALS

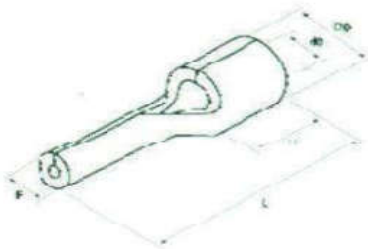

Material

Terminal : ETP Copper
Finish : Tin Plated

Part No.	Dimension(mm)				
	F	L	H	D	d
PBR 1.5-9	1.9	13.8	4.8	3.4	1.7
PBR 1.5-10	1.9	14.8			
PBR 1.5-12	1.9	16.8			
PBR 1.5-13	1.9	17.8			
PBR 1.5-18	1.9	22.8			
PBR 2.5-9	1.9	13.8	4.8	4.1	2.3
PBR 2.5-10	1.9	14.8			
PBR 2.5-12	1.9	16.8			
PBR 2.5-13	1.9	17.8			
PBR 2.5-18	1.9	22.8			
PBR 4-10	2.8	14.8	6.0	5.0	3.0
PBR 4-13	2.8	19.8			
PBR 6-13	2.8	19.8			

COPPER FORK TYPE TERMINALS INSULATED

Material

Insulation : Flared PVC

Terminal : ETP Copper

Finish : Tin Plated

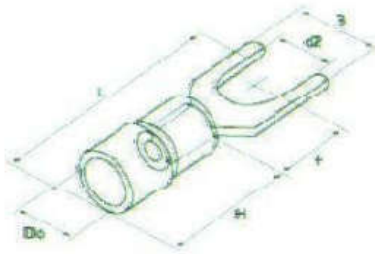

Part No.	Stud Size	Dimension(mm)						Color
		d2	B	L	F	H	D	
CFI 1.5-3.2	#4	3.2	5.7	21.2	6.5			Red
CFI 1.5-3.5S	#6	3.7	5.7	21.2	6.5			
CFI 1.5-3.5L	#6	3.7	6.4	21.2	6.5			
CFI 1.5-4	#8	4.3	6.4	21.2	6.5			
CFI 1.5-4M	#8	4.3	7.2	21.2	6.5			
CFI 1.5-4L	#8	4.3	8.1	21.2	6.5	10.0	4.3	
CFI 1.5-4S	#10	5.3	8.1	21.2	6.5			
CFI 1.5-5L	#10	5.3	9.5	21.2	6.5			
CFI 1.5-6	1/4	6.4	9.5	21.2	6.5			
CFI 1.5-6L	1/4	6.4	12.0	27.2	11.0			
CFI 1.5-8	5/16	8.4	14.0	29.0	12.5			
CFI 2.5-3.2	#4	3.2	5.7	21.2	6.5			
CFI 2.5-3.5S	#6	3.7	5.7	21.2	6.5			
CFI 2.5-3.5L	#6	3.7	6.0	21.2	6.4			
CFI 2.5-4S	#8	4.3	6.4	21.2	6.5			
CFI 2.5-4M	#8	4.3	7.2	21.2	6.5			
CFI 2.5-4L	#8	4.3	8.1	21.2	6.5	10.0	4.9	
CFI 2.5-5S	#10	5.3	8.1	21.2	6.5			
CFI 2.5-5L	#10	5.3	9.5	21.2	6.5			
CFI 2.5-6S	1/4	6.4	9.5	21.2	6.5			
CFI 2.5-6L	1/4	6.4	12.0	27.2	11.0			
CFI 2.5-8	5/16	8.4	14.0	29.0	12.5			
CFI 4-6-3.5	#6	3.7	8.3	25.2	7.5			Yellow
CFI 4-6-4S	#8	4.3	8.3	25.2	7.5			
CFI 4-6-4L	#8	4.3	9.0	25.2	7.5			
CFI 4-6-5	#10	5.3	9.0	25.2	7.5	13.0	6.7	
CFI 4-6-6S	1/4	6.4	9.0	25.2	7.5			
CFI 4-6-6L	1/4	6.4	12.0	31.2	12.0			
CFI 4-6-8	5/16	8.4	14.0	30.0	11.5			

COPPER RING TERMINALS INSULATED

Material

Insulation : Flared PVC

Terminal : ETP Copper

Finish : Tin Plated

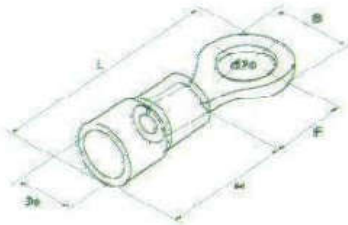

Part No.	Stud size	Dimension(mm)						Color
		d2	B	L	F	H	D	
CRI 1.5-3.2	#4	3.2	5.7	17.8	4.95	10.0	4.3	Red
CRI 1.5-3.5	#6	3.7	5.7	17.8	4.95			
CRI 1.5-3.5M	#6	3.7	6.6	20.1	6.3			
CRI 1.5-3.5L	#6	3.7	8.0	21.5	7.0			
CRI 1.5-4S	#8	4.3	6.6	20.1	6.3			
CRI 1.5-4L	#8	4.3	8.0	21.5	7.0			
CRI 1.5-5S	#10	5.3	8.0	21.5	7.0			
CRI 1.5-5L	#10	5.3	9.8	23.0	8.5			
CRI 1.5-6S	1/4	6.4	9.8	23.0	8.5			
CRI 1.5-6	1/4	6.4	11.6	27.5	11.1			
CRI 1.5-8	5/16	8.4	11.6	27.5	11.1			
CRI 1.5-10	3/8	10.5	13.6	31.6	13.9			
CRI 1.5-12	1/2	13.0	19.2	36.0	16.5			
CRI 2.5-3.2	#4	3.2	6.6	17.8	4.3	10.0	4.9	Blue
CRI 2.5-3.5S	#6	3.7	6.6	17.8	4.3			
CRI 2.5-3.5M	#6	3.7	6.6	21.0	7.0			
CRI 2.5-3.5L	#6	3.7	8.5	22.5	7.75			
CRI 2.5-4	#8	4.3	6.6	21.0	7.0			
CRI 2.5-4L	#8	4.3	8.5	22.5	7.75			
CRI 2.5-5S	#10	5.3	8.5	22.5	7.75			
CRI 2.5-5L	#10	5.3	9.5	22.5	7.25			
CRI 2.5-6	1/4	6.4	12.0	27.0	11.0			
CRI 2.5-8	5/16	8.4	12.0	27.6	11.0			
CRI 2.5-10	3/8	10.5	13.6	30.2	13.9			
CRI 2.5-12	1/2	13.0	19.2	36.5	16.5			
CRI 4-6-3.5	#6	3.7	7.2	21.4	5.0	13.0	6.7	Yellow
CRI 4-6-4S	#8	4.3	7.2	21.4	5.9			
CRI 4-6-4	#8	4.3	9.5	26.5	8.3			
CRI 4-6-5	#10	5.3	9.5	25.5	8.3			
CRI 4-6-6	1/4	6.4	12.0	31.5	13.0			
CRI 4-6-8	5/16	8.4	15.0	33.7	13.7			
CRI 4-6-10	3/8	10.5	15.0	33.7	13.7			
CRI 4-6-12	1/2	13.0	19.2	38.1	16.0			